

LEGEND:

EXISTING WATERMAIN	---
PROPOSED WATERMAIN 150mm Ø MDPE - SEE IW COP	---
PROPOSED SLUICE VALVE	SV
PROPOSED AIR VALVE	AV
PROPOSED HYDRANT	H
PROPOSED BULK METER	B
PROPOSED BOUNDARY BOX (INDIVIDUAL HOUSE CONNECTION)	BB
PROPOSED THRUST BLOCK	TB
RED LINE BOUNDARY	---
PROPOSED OFF-LINE WASHOUT HYDRANT	W

- NOTE:**
- ALL PIPE WORK, VALVES, CHAMBERS, NETWORK ARRANGEMENTS AND ALL ASSOCIATED WATERMAIN WORKS TO COMPLY WITH THE IRISH WATER INFRASTRUCTURE STANDARD DETAILS.
 - ALL NEW WATERMAIN MATERIAL SHALL BE IN ACCORDANCE WITH SECTION 3.9 OF THE IRISH WATER CODE OF PRACTICE. MDPE PIPES SHALL BE OF A TYPE PE-80 AND HAVE AN SDR-11 RATING. THEY SHALL CONFORM TO IS EN 12201: PART 1, PART 2, AND PART 3.
 - THE PROPOSED WATERMANS WILL BE LOCATED A MINIMUM OF 300mm FROM THE WASTEWATER INFRASTRUCTURE IN ACCORDANCE WITH SECTION 3.5.18 OF THE IRISH WATER WASTEWATER CODE OF PRACTICE AND TYPICAL SERVICE LAYOUT DISTANCES (HORIZONTAL AND VERTICAL) SHALL BE AS PER IRISH WATER STANDARD DETAIL STD-W-11.
 - AIR PRESSURE TESTS TO ALL WORKS TO BE TAKEN IN CHARGE TO IRISH WATER CODE OF PRACTICE SECTION 4.10.
 - MANIFOLD CHAMBERS WILL BE USED TO PROVIDE A COMMUNAL BOX FOR THE APARTMENT BLOCK AND THAT EACH DWELLING UNIT WILL HAVE ITS OWN SUPPLY PIPE AND METER AND STOP VALVE. ALL METERS IN THE MANIFOLD SHALL BE TAGGED TO INDICATE WHICH PROPERTY IS SUPPLIED AND ANY UNUSED OUTLETS WILL BE BLANKED OFF IN ACCORDANCE WITH SECTION 3.15.3 OF THE IRISH WATER WASTEWATER CODE OF PRACTICE.
 - BULK METERS SHALL COMPLY WITH SECTION 3.15.4 OF THE IRISH WATERS CODE OF PRACTICE FOR WATER INFRASTRUCTURE.
 - EACH HOUSE SHALL HAVE AN INDIVIDUAL CONNECTION WITH BOUNDARY BOX AS PER SECTION 3.15.2 OF THE IRISH WATERS CODE OF PRACTICE FOR WATER INFRASTRUCTURE. IN SOME CASES THE HOUSE SERVICE CONNECTION IS GREATER THAN 15m IN LENGTH. A SERVICE CONNECTION OF 32mm Ø TO BE USED IN LOCATIONS WHERE THE SERVICE CONNECTION IS GREATER THAN 15m IN LENGTH, FOLLOWING APPROVAL FROM IRISH WATER.
 - WATERMAIN T-JUNCTIONS SHALL BE AT 90 DEGREE ANGLES AS PER IRISH WATER DETAIL STD-W-07.
 - THRUST BLOCKS TO BE PROVIDED AT DEAD ENDS, BENDS, TEE JUNCTIONS, VALVE CHAMBERS (AS PER DETAILS) OR ANY ABRUPT CHANGE IN VERTICAL OR HORIZONTAL DIRECTION AND AT ANY LOCATION WHERE WATER PRESSURE IS LIKELY TO DISTORT THE PIPE LINE INSTALLATION OR CAUSE DISPROPORTIONATE MOVEMENT. THRUST BLOCKS TO BE IN ACCORDANCE WITH SECTION 4.9 OF THE IRISH WATER CODE OF PRACTICE AND IRISH WATER STANDARD DETAIL STD-W-28.
 - ANY NEW PLANTING OF TREES, SHRUBS ETC. TO BE IN STRICT ACCORDANCE WITH THE IRISH WATER STANDARD DETAIL STD-W-12A. ANY PROPOSED WATERMAIN LOCATED IN PROXIMITY TO EXISTING TREES SHALL BE IN ACCORDANCE WITH STANDARD IRISH WATER DETAIL STD-W-12.
 - SCOUR VALVE TO BE LOCATED AT SITE LOW POINT. THE SCOUR CHAMBER IS TO BE PROVIDED WITH A NON-RETURN VALVE TO PREVENT BACK FLOW TO THE WATER SUPPLY NETWORK AND AGREED WITH THE LOCAL AUTHORITY. SCOUR VALVE AND CHAMBER TO COMPLY WITH SECTION 3.16.4 AND 3.21 OF THE IRISH WATER CODE OF PRACTICE. LOCALISED LOW POINTS ARE TO BE SCOURED BY MEANS OF A WASHOUT HYDRANT AS PER SECTION 3.22 OF THE IRISH WATER CODE OF PRACTICE.
 - NOTE: THE FIRE SAFETY CERTIFICATE HAS NOT BEEN COMPLETED YET, BUT AS PART OF THIS DEVELOPMENT, IT IS CONFIRMED THAT HYDRANTS SHALL NOT BE LOCATED ANY MORE THAN 46m FROM ANY PART OF THE DEVELOPMENT UNITS.

NOTE:
FOR WATERMAIN STANDARD DETAILS REFER TO DRAWINGS D061-026, D061-027.

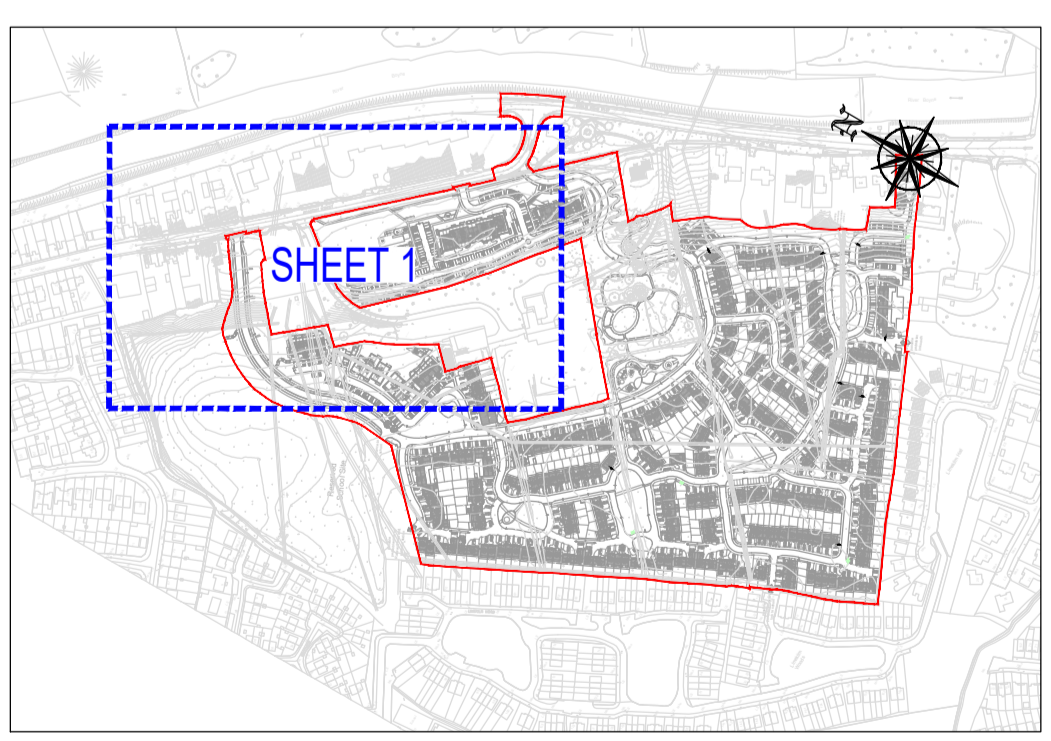
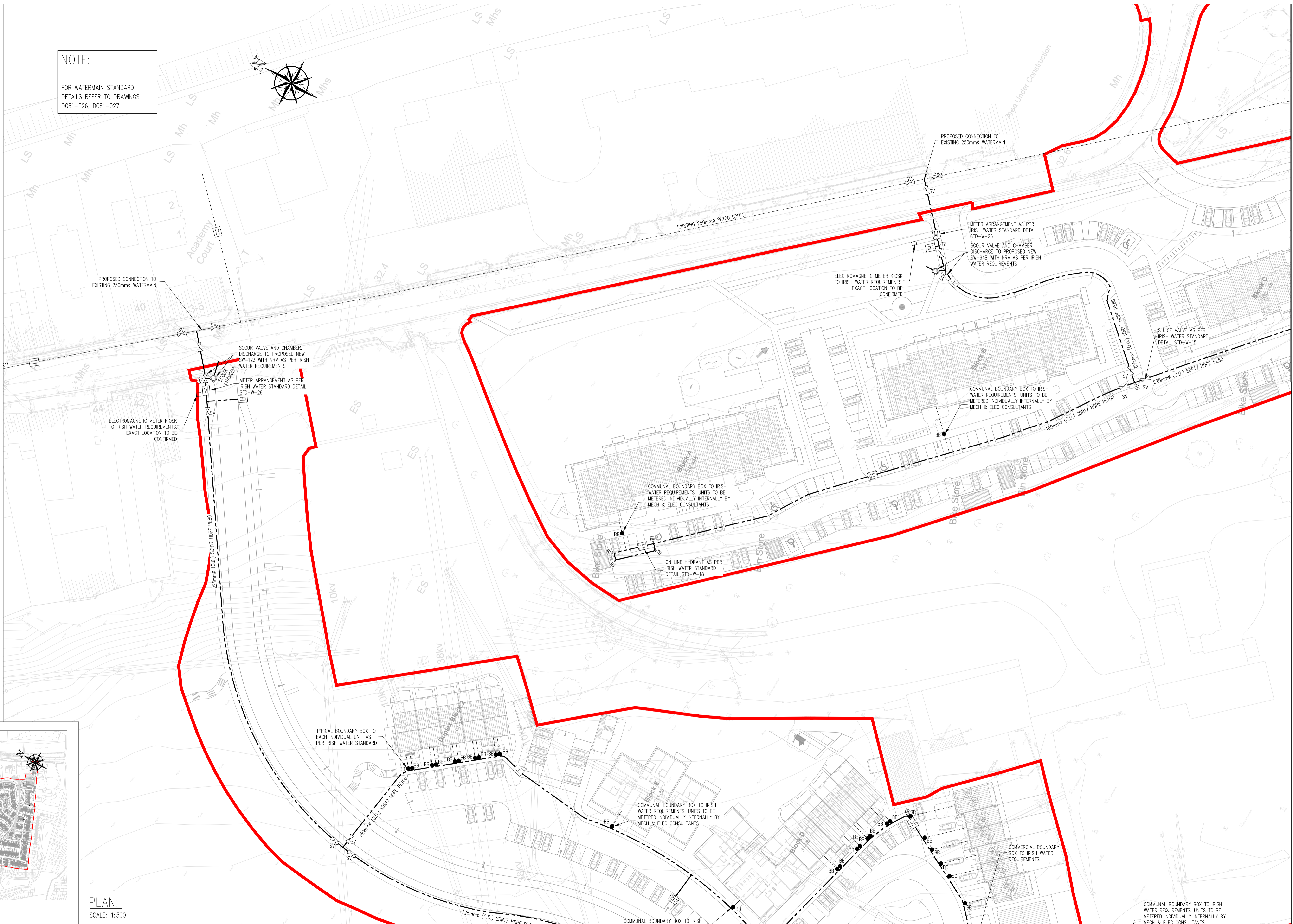

PLAN:
SCALE: 1:500

PLANNING DRAWING
NOT FOR CONSTRUCTION THIS DRAWING HAS BEEN ISSUED FOR INFORMATION PURPOSES ONLY AND MUST NOT BE USED FOR CONSTRUCTION UNDER ANY CIRCUMSTANCES

- NOTES**
- For setting out refer to Architect's drawings.
 - This drawing to be read in conjunction with all other Architectural and Engineering drawings and all other relevant drawings and Specifications.
 - DO NOT SCALE THIS DRAWING. Use figured dimensions only.
 - No part of this document may be reproduced or transmitted in any form or stored in any retrieval system of any nature without the written permission as copyright holder except as agreed for use on the project for which the document was originally issued.
 - Ordnance Survey Ireland Licence Number EN 0074019

Rev. No.	Date	REVISION NOTE	Drn. By	Chkd. By
A	01.10.2019	ARCHITECT'S LAYOUT REVISED	JS	NB
B	01.11.2019	ISSUED TO IRISH WATER	DD	RFM
C	05.11.2019	REVISED FOLLOWING COMMENTS FROM IRISH WATER. REVISIONS AS CLOUDED	DD	RFM
D	19.11.2019	LOOP AND HYDRANT REMOVED. HYDRANTS REPOSITIONED FOLLOWING COMMENTS FROM IRISH WATER	DD	RFM
E	19.11.2019	ISSUED FOR PLANNING	DD	RFM

Drn. By	Chkd. By	Architect	Project
JC	NB	Conroy Crowe Kelly	Belmont
Date	Scale	Title	
Mar 2019	1:500 @ A1	Watermains Layout Sheet 1 of 4	

Drn. By	Chkd. By	Appr. By	Dwg. No.	Revision
JC	NB	NB	D061/022	E

CS Consulting Group
DUBLIN | LONDON | LIMERICK

Head Office
19-22 Dame Street, Dublin 2.
T: +353 (0)1 5480863 F: +353 (0)1 9011355
e: info@csconsulting.ie
w: www.csconsulting.ie

Quality
Environment
Energy
Health & Safety

IS. EN ISO 9001:2008
IS. EN ISO 14001:2004
IS. EN ISO 50001:2011
OHSAS 18001:2007